

1 Cautions

This section contains important information to ensure the user's safety and prevent potential damage to property. Please, read this section carefully and use the product accordingly.

▲ NOTES

- Master PIN Code: Default Master PIN code is [12345678] please modify it immediately.
- User PIN Code: It can be 6~12 digits number. You can register and up to 10 groups.

User Number	User Type	Notes
00-04	Normal User	*Permanent
05-08	Temporary User	*Invalid after using one time or invalid in safety mode
09	Duress User	*Working with wireless module when duress event occurs

- Card: It is optional. Maximum capacity is 100 with user number [00-99].
- Fingerprint: Maximum capacity is 100 with user number [00-99]
- Be sure to correctly match the poles (+/-) when installing the batteries.Install the batteries with the correct poles (+/-).
- Replace all batteries immediately after they run out of power, and never mix new batteries with used ones.

Model	Open Door Index	Menu Table	Menu Access
L7-5	PIN Code - 6.1.1 Fingerprint - 6.1.2 Card - 6.1.3	5.1 Enroll User PIN Code	Master PIN Code
		5.2 Enroll Fingerprint	
		5.3 Enroll Card	
		5.4 Delete User PIN Code	
L7-2	PIN Code - 6.1.1 Card - 6.1.3	5.5 Delete Fingerprint	Master PIN Code
		5.6 Delete Card	
		5.7 Opening Mode Setting	
		5.9 Change Master PIN Code	

Overview

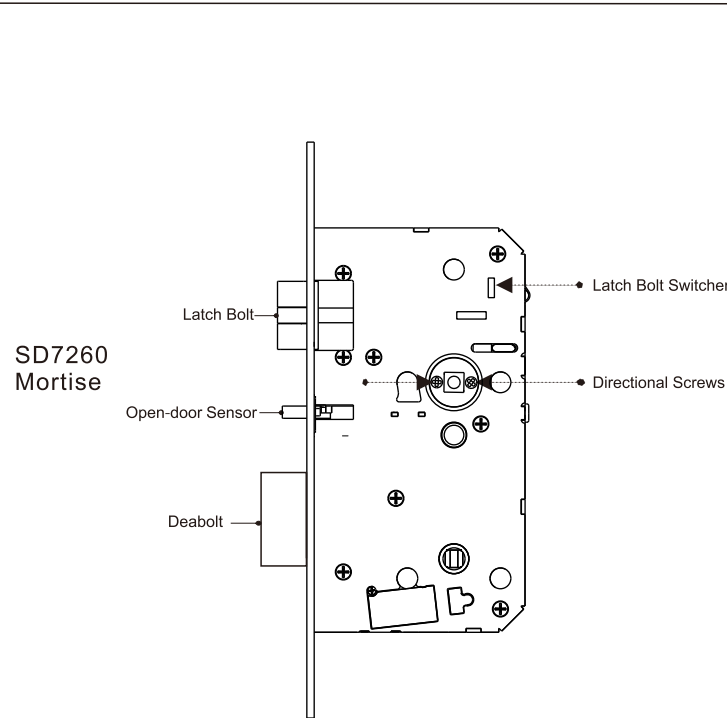
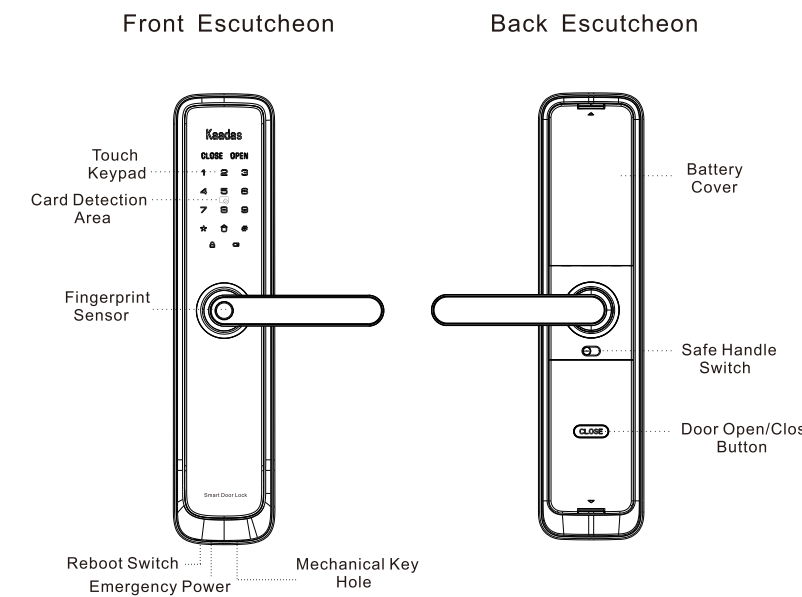

1.1 Change Screws Position and Latch Bolt Direction

For left open or right open, please change the position of directional screws by following instructions.

Make sure the position of 2 directional screws is faced to the indoor direction, then fasten them properly. So that it makes panic open by handle from indoor.

For inward open or outward open, please change the facing direction of latch bolt by following instructions.

Move latch bolt switcher into the other end by turning mortise upside down. Then push latch bolt inside the mortise, turn round 180 degree ,and eject it.

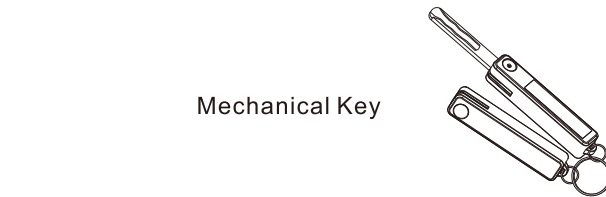

▲ Notes The product components used may vary depending on the installation environment and model number.

2 Package Content and Explosive View

This described package content is for reference only, the real products should be considered as final. If some components lost, please check with the sellers.

Number	Item Name	Quantity	Remark
1	Front escutcheon with rubber gasket	1	
2	Back escutcheon with rubber gasket	1	
3	Mortise	1	
4	Mounting Accessory Kit	1	
5	User Manual	1	
6	Micro-fiber Wiper	1	
7	Warranty Card	1	
8	The Seal Box of Key	1	2 Pieces Mechanical Key
9	Strike Plate Assembly	1	
10	Installation Template	1	
11	Mounting Plate	1	
12	RFID Card	2	
13	Network Module	1	Optional

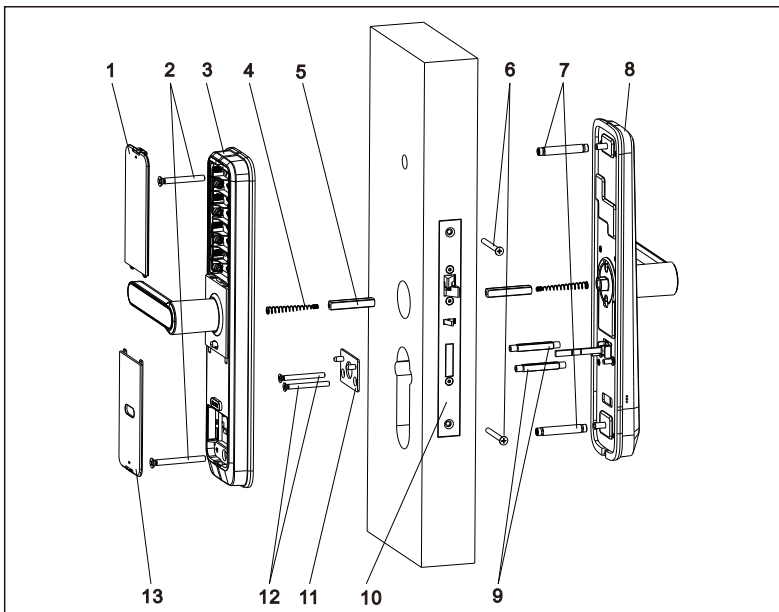

- Battery Box (1 pc)
- Mounting Screw (2 pcs)
- Back Escutcheon Assembly (1 pc)
- Pressure Spring (2 pcs)
- Square Shaft (2 pcs)
- Mortise Plate Screw (2 pcs)
- Connecting Screw Bolt (2 pcs)
- Front Escutcheon Assembly (1 pc)
- Connecting Screw Bolt (2 pcs)
- Mortise (1 pc)
- Mounting Plate (1 pc)
- Mounting Plate Screw (2 pcs)
- Bottom Cover (1 pc)

3 Before Installation

3.1 Check Door Open Direction

This product fits for all open direction - Left-in/Left-out/Right-in/Right-out.

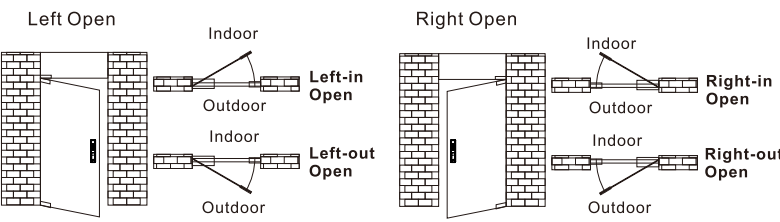

3.2 Change Handle Direction

Please fix the screws in proper locations according to below diagram in different open direction.

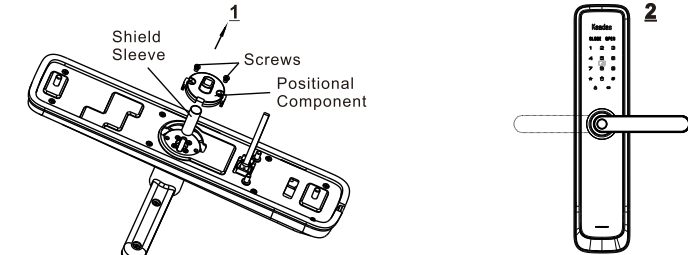

- Taking out screws, positional component and shield sleeve in proper order.
- Rotating the handle to the other end.

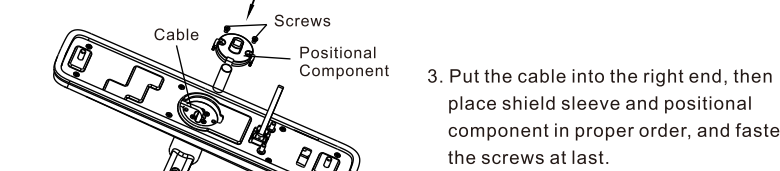

▲ NOTES Following the same steps to change handle direction for back escutcheon.

3.3 Change Screws Position and Latch Bolt Direction

Follow the instructions of chapter [1.1] to make the mortise fit for different open direction.

3.4 Check Door Thickness

The standard mounting accessory kit is used for the door thickness of 30 - 60mm.

3.5 Cut The Mechanical Key Pick

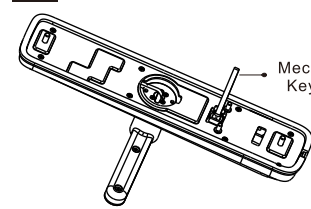

According to door thickness, cut the mechanical key pick into proper length. The proper length of key pick is required to be more than half of door thickness, but not pass through the door.

4 Installation Steps

- 4.1 Mark and drill bores by using the installation template first, then fix the mortise into the door frame.

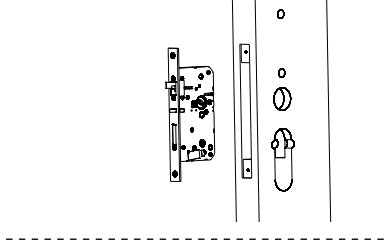

- 4.2 Tighten the 2 screws to fix the mortise on the door.

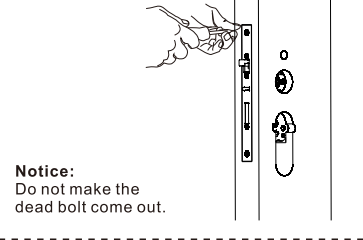

Notice: Do not make the dead bolt come out.

- 4.3 Fix 4 screw bolts on the front escutcheon, place square shaft and pressure spring into the bore.

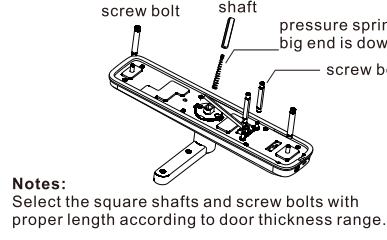

- 4.5 Install the mounting plate with fixing screws tightly against the door surface.

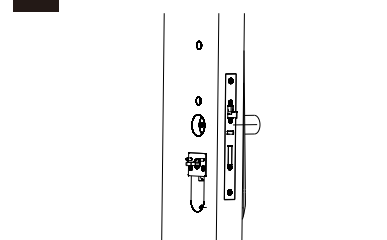

- 4.4 Pass the connection wire through the top bore. Then align and insert square shaft into mortise holes to make the front escutcheon against the door closely.

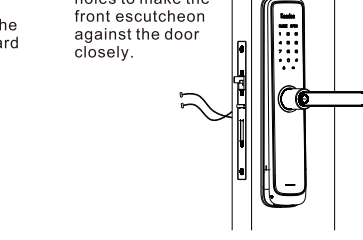

- 4.6 Place pressure spring and square shaft in the back escutcheon in proper order.

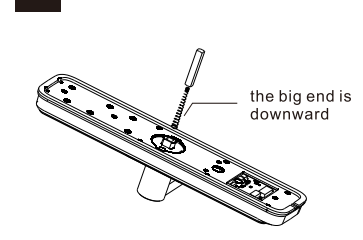

- 4.7 Insert the connecting wires of front escutcheon into the related sockets of the back escutcheon. Then align and insert the square shaft into mortise hole, make the back escutcheon against the door closely.

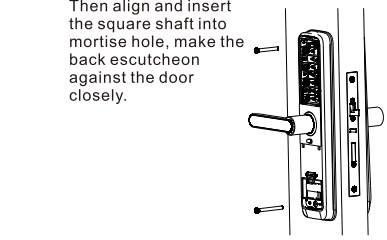

- 4.8 Tighten the 2 fixing screws.

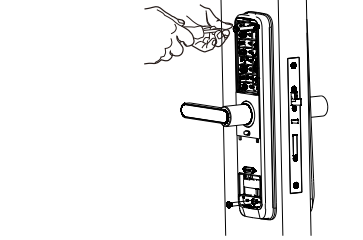

- 4.9 Install the batteries and the battery cover. Then install the striker assembly to finish installation.

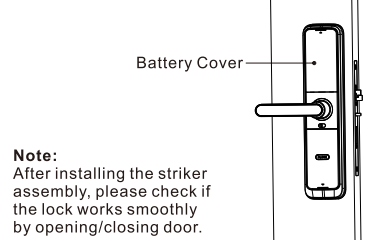

Note: After installing the striker assembly, please check if the lock works smoothly by opening/closing door.

- 4.10 Please check handle, safe handle switch and mechanical key if they are working properly.

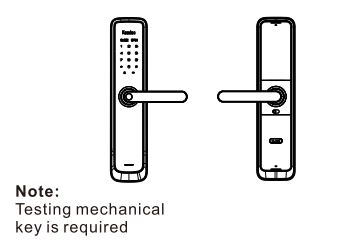

Note: Testing mechanical key is required

5 How To Program

5.1 How to access into master mode

- Touching the keypad area will light up number pad.
- Press [*][*] (* twice), then enter master PIN code [default is 12345678] with end of [#]. Voice prompt "Master mode"

▲ NOTES

Change master PIN code is required immediately for menu operation.

5.2 Menu Table

	(L7-5)	Or	(L7-2)
Press[1]	1 Enroll User PIN Code 2 Enroll Fingerprint 3 Enroll Card 4 Delete User PIN Code 5 Delete Fingerprint 6 Delete Card 7 Opening Mode Setting 9 Change Master PIN Code		1 Enroll User PIN Code 2 Enroll Card 3 Enroll Fingerprint 4 Delete User PIN Code 5 Delete Card 6 Delete Fingerprint 7 Opening Mode Setting 9 Change Master PIN Code
Press[2]	3 Volume Setting 4 Language Setting		
Press[3]	1 System Query		
Press[4]	1 Join Network 2 Log off Network	(Optional)	
Press[5]	1 Connect Bluetooth 2 Disconnect Bluetooth 3 Disable Bluetooth		

▲ NOTES

- You can operate following the voice guide.
- The length of both master PIN code and user PIN code is 6-12 digits.
- Enter [400#] will get Serials Number.

User Setting

Enroll User PIN Code

1	Access into master mode, press [1] for user setting. Then press [1] to enroll user PIN code.
1 2 3 4 5 6 7 8 9	# Enter 2 digital user number (00-99), and confirm with [#] key.
1 2 3 4 5 6 7 8 9	# Enter user PIN code (6-12 digits), and confirm with [#] key; Then repeat above operations. Voice prompt of "settings succeed"

▲ NOTES Refer to 1 Cautions. [00-94]: Normal User; [05-08]: Temporary User; [09]: Duress User.

Enroll Fingerprint

2	Access into master mode, press [1] for user setting. Then press [2] to enroll user fingerprint.
1 2 3 4 5 6 7 8 9	# Enter 2 digital user number (00-99), and confirm with [#] key.
	Place your finger on the fingerprint sensor, then take away your finger after voice prompt "Remove finger and scan again". Repeat above steps 8 times until voice prompt "settings succeed"

▲ NOTES Refer to 1 Cautions. [00-94]: Regular fingerprint; [95-99]: Duress fingerprint.

Enroll Card

3	Access into master mode, press [1] for user setting. Then press [3] to enroll user card.
1 2 3 4 5 6 7 8 9	# Enter 2 digital user number (00-99), and confirm with [#] key.
	Place card on the card icon area until beep sound and voice prompt "settings succeed".

Delete User PIN Code

- 4

Access into master mode, press [1] for user setting. Then press [4] to delete user PIN code.
- 1

Press [1] to delete single user
- 1 2 3
4 5 6
7 8 9

#

Enter 2 digital user number (00-99), and confirm with [#] key. Voice prompt of "Deletion succeeded"
- 2

Press [2] to delete all users
Voice prompt of "Deletion succeeded"

Delete User Fingerprint

- 5

Access into master mode, press [1] for user setting. Then press [5] to delete user fingerprint.
- 1

Press [1] to delete single user
- 1 2 3
4 5 6
7 8 9

#

Enter 2 digital user number (00-99), and confirm with [#] key. Or Place the related finger on the fingerprint sensor to delete until one beep sound.
Voice prompt of "Deletion succeeded"
- 2

Press [2] to delete all users
Voice prompt of "Deletion succeeded"

Delete User Card

- 6

Access into master mode, press [1] for user setting. Then press [6] to delete user card.
- 1

Press [1] to delete single user
- 1 2 3
4 5 6
7 8 9

#

Enter 2 digital user number (00-99), and confirm with [#] key. Or Place the related RF card on the card icon area to delete until one beep sound.
Voice prompt of "Deletion succeeded"
- 2

Press [2] to delete all users
Voice prompt of "Deletion succeeded"

Opening Mode Setting

- 7

Access into master mode, press [1] for user setting. Then press [7] for opening mode setting.
- 1

Press [1] for normal mode (single verification), which means opening by PIN code or fingerprint or card.
- 2

Press [2] for security mode (double verification), which means opening by PIN code+fingerprint or PIN code +card or fingerprint+card

NOTES In security mode, to delete all users is prohibited

Change Master PIN Code

- 9

Access into master mode, press [1] for user setting. Then press [9] to change master PIN code.
- 1 2 3
4 5 6
7 8 9

#

Enter new master PIN code (6-12 digits) and confirm with [#] key. Then repeat above operations.
Voice prompt of "settings succeed"

NOTES Change master PIN code is required immediately after installation.

System Setting

Volume Setting

- 2 3

Access into master mode, press [2] for system setting. Then press [3] for volume setting.
- 1

Press [1] for voice mode.
- 2

Press [2] for mute mode, excluding alarm and menu operation.

Language Setting

- 2 4

Access into master mode, press [2] for system setting. Then press [4] for language setting.
- 1

Press [1] for Chinese Voice.
- 2

Press [2] for English Voice.
- 3

Press [3] for Spanish Voice.
- 4

Press [4] for Portuguese Voice.

System Query

- 3

Access into master mode, press [3] for system query.
- 1

Press [1] to get unique Serials Number.

Bluetooth Setting

- 5 1

Access into master mode, press [5] for bluetooth setting. Then press [1] to enable bluetooth.
- 1

Press [1] to connect bluetooth.
- 2

Press [2] to disconnect bluetooth.
- 3

Press [3] to disable bluetooth.

6 How to use

6.1 Normal Mode

6.1.1 Open door by PIN code

1. Touch pad screen by palm to lighten keypad
2. Enter the enrolled PIN code with end of [#]. Voice prompt "door opened"
3. Press down the handle to open the door

NOTES The random numbers can be added before and after the real PIN code, this prevents the user PIN code from being exposed. The maximum length is 32 digits.

6.1.2 Open door by Fingerprint

1. Place the enrolled finger properly on the fingerprint sensor area until one beep sound and voice prompt "door opened"
2. Press down the handle to open the door

6.1.3 Open door by Card

1. Place the enrolled card properly on the card icon area until one beep sound and voice prompt "door opened"
2. Press down the handle to open the door

6.2 Security Mode

In security mode, double verification is required for opening door.

1. PIN Code + Fingerprint
2. PIN Code + Card
3. Fingerprint + Card

6.3 Open door by mechanical key

In case of forgetting PIN code, battery run out or system error; Mechanical key is used to open door as backup mode.

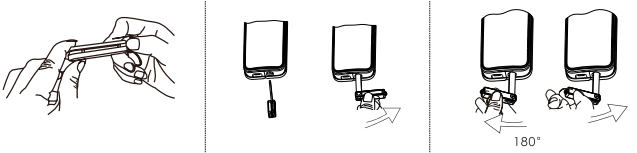

Insert the key into key hole and rotate it with proper angles. Then rotate the handle to open the door

6.4 Auto /Manual Mode

1. Taking out battery cover to find the A/M switch.
2. [A] means auto mode: when door is closed, the deadbolt will be driven out automatically, then door will be in locked status.
3. [M] means manual mode: when door is closed, the deadbolt will not be driven out, then the door will be in unlocked status.

NOTES In manual mode, once the door is closed, please verify user fingerprint / PIN code / card to lock the door from outside.

6.5 CLOSE button

1. Click [CLOSE] button to lock the door.
2. Double click [CLOSE] button to open the door.
3. Long press [CLOSE] button to double lock the door. The privacy mode will be enabled, only Master PIN code and key can open the door from outside. User PIN code / Fingerprint / Card is prohibited.

6.6 Locking Operation

6.6.1 Auto locking

In auto mode, door will be locked automatically in 1.5 seconds after closing. Voice prompts "door closed"

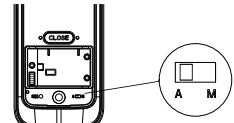

6.6.2 Manual locking

In manual mode, click [CLOSE] button to lock the door from inside or verify user fingerprint / PIN code / card to lock the door from outside. Voice prompts "door closed"

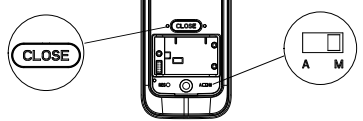

6.6.3 Double locking

When door is locked, long press [CLOSE] button to double lock the door. Voice prompts "Inside deadlock enabled"

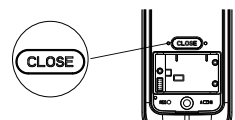

NOTES If incorrect fingerprint/PIN code/card are attempted 10 times in a row, the related verification method will be lockout for 5 minutes. In this case, please use the alternative method to open the door.

6.7 Defense Mode

1. Enable: After door is locked, press [DEFENSE] button to enable defense mode. Voice prompt "Outside forced lock enabled". In this mode when the door is unlocked from inside, the alarm will be triggered.
2. Disable: Once the door is opened properly from outside, the defense mode will be disabled.



6.8 Safe Handle Feature

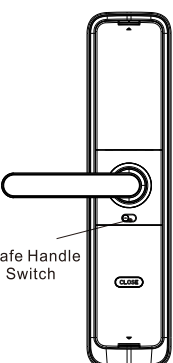

1. Enable: move the safe handle switch to display 'red' mark. Once safe handle feature is enabled, the indoor handle will be locked.
2. Disable: move the safe handle switch to display 'green' mark. The indoor handle can be down freely.

6.9 Mute/Voice Switch

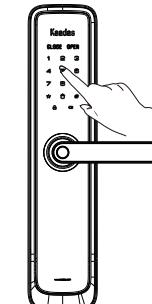

Voice > Mute : When default setting is voice mode, long press [#] button to enable mute mode. After the lock go back to sleeping status, mute mode will be disabled automatically.

Mute > Voice : When default setting is mute mode, long press [#] button to enable voice mode. After the lock go back to sleeping status, voice mode will be disabled automatically.

6.10 Restore To Factory Setting

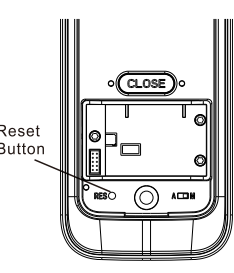

Long press [RES] button for 5 seconds to make the lock restore to factory setting. Voice prompt "Restored to factory settings. Change master PIN code." After that, all user information and settings will be cleared.

NOTES After the lock is restored to factory setting, all users and settings will be cleared. The masterPIN code will be changed into [12345678] and required for changing immediately.

6.11 Emergency Power Supply

When the battery voltage is too low to open the lock from outside, you can use 5V power bank to charge the door lock via Micro USB port. After the door is unlocked, please replace all batteries immediately.

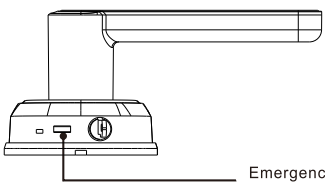

NOTES When battery voltage is lower than 4.8V, voice prompts "Low battery, please replace all batteries" at each unlocking. Please replace all batteries immediately, and do not mix old batteries and new batteries together in replacement.

6.12 Replace Battery

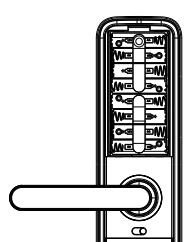

1.5V AA Alkaline Battery is required. Total is 8 pcs, divided into 2 groups.

One group is ok for power supply, two groups is used for longer time.

6.13 Extended Function(optional)

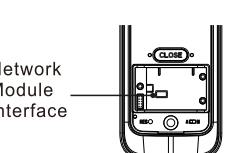

Access into master mode, press [4] for function extension, which is reserved for Z-Wave and other smart home interface.

Please contact Kaadas distributor for more details.

4

Access into master mode, press [4] for extended function.

1

Press [1] to join network.

2

Press [2] to log off network.